

Exploded View of Air Inlet End (A)

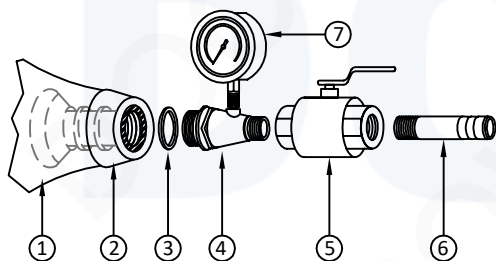

Exploded View of Air Tightness Swivel End (S)

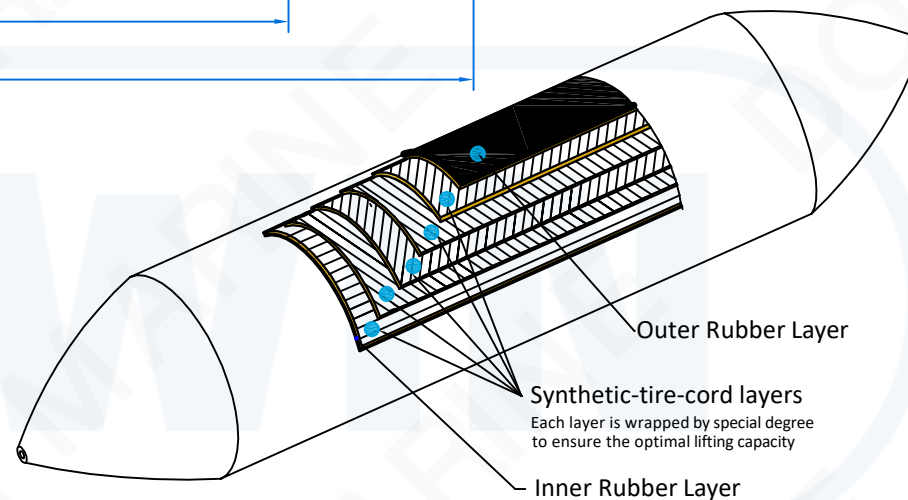
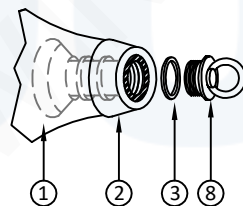

Unique Holistic Wrapping Technology (Helical Pattern)

The air bag made by this technology has better bearing capacity than the traditional "Connecting Type" and "Surface Wrapping Type" air bag.

- B -- Body of Air Bag
- H -- Header of Air Bag
- A -- Air Inlet End
- S -- Air Tightness Swivel End
- D -- Diameter of Air Bag
- L/EL -- Effective Length of Air Bag
- LoA/TL -- Total Length of Air Bag

Note

1. Do not scale.
2. This drawing illustrate the standard structure and accessorie each air bag system. All these item will supplied as the whole system.
3. Please the practicality as standard.
4. The stainless steel end fitting can be supplied.

QTY	Part No.	Description	Size	Material	Remark
1	8	End Swivel	---	SS400	Zn-Galv'd
1	7	Liquid Filled Air Pressure	---	---	HAKIN
1	6	Short Steel	3/4"	SS400	Zn-Galv'd
1	5	Ball Valve	3/4"	SS	---
1	4	Three-Direction Connector	---	SS400	Zn-Galv'd
2	3	Sealing Wahser	---	Silica Gel	---
2	2	End Flange	---	SS400	Zn-Galv'd
2	1	The End of Air Bag Body	---	Rubber	---

REV.	DATE	BY	DESCRIPTION	TITLE: SHIP LAUNCHING AIRBAGS STRUCTURE			
				CLIENT:			
				QUALITY MANAGEMENT STANDARD: ISO 14409 Latest Edition			
				DWG. NO.: P-1350*2500-50/80 TYPE: (CHAIN & TIRE) NET TYPE			
REVISION				DOOWIN	DO NOT SCALE		
DES.BY.		DRN.BY.				SHEET	
DRN.BY.		APR.BY.					Rev.No.
CHK.BY.		DATE	01.01.2022				
				© 2022 QINGDAO DOOWIN MARINE ENGINEERING CO.,LTD			
				1 OF 1 01			

Wangjiacao Industry Park, Xiazhuang, Chengyang, Qingdao, PRC
Tel/Fax: +86-532-8778 8178 Email: sales@doowinmarine.com